

CMC-Series



Connectronics Multi-Contact High Voltage Connectors

Features:

- Corona Resistant Tapered Interface
- 10 thru 50 KVDC Operating Voltage
- Temperature Range
-55°C to +125°C
- Sea Level to 70,000 Ft. Operation
- Field or Factory Assembled
- Use W/ Shielded or Unshielded Cable
- Various Hardware Platings Available

Typical Applications:

- Electronic Countermeasures
- Radar
- CRT Displays
- Traveling Wave Tubes
- High Voltage Power Supplies
- Medical Applications
- UV Curing Equipment

Connectronics 
Corp. *Interconnection Specialists*
a **HEICO** company



Corporate Office
& Manufacturing Facilities:
2745 Avondale • P.O. Box 3355
Toledo, Ohio 43607

Phone: 419-537-0020
Fax: 419-537-0007
E-mail: info@connectronicscorp.com
Visit Us On Our Web Site @
www.connectronicscorp.com

CMC Series CONNECTOR SHELL DATA

BOX MT. RECEPTACLE

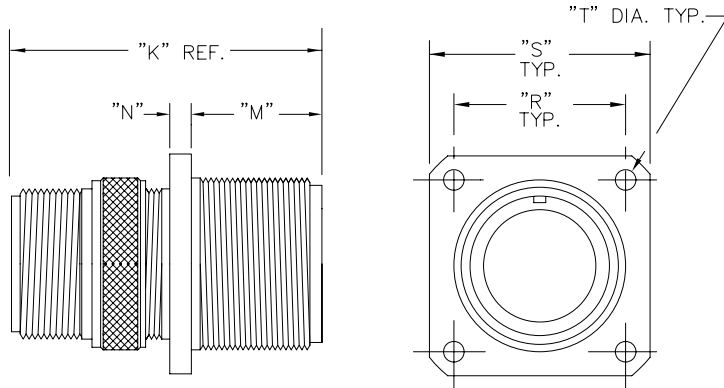

STRAIGHT PLUG

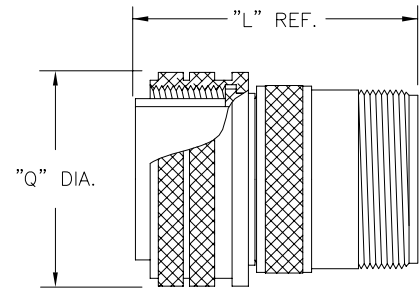

RECEPTACLE ASSEMBLIES ARE AVAILABLE WITHOUT BACKSHELL AND THREADS ON BACKEND OF SHELL CONSULT FACTORY FOR PART NUMBERS AND AVAILABILITY

OPTIONAL - HEX COUPLING NUT AVAILABLE - CONSULT FACTORY FOR AVAILABILITY

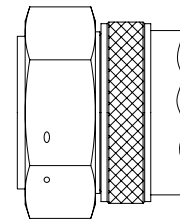

| SHELL SIZE | "A" MATING THD. | "K" | "L" | "M" MAX. | "N" MAX. | "Q" DIA. MAX. | "R" | "S" | "T" DIA. | "V" THREAD | |
|------------|-----------------|------|------|----------|----------|---------------|-----------|-----------|----------------|----------------|--------------|
| 12S | 3/4-20 UNEF | 1.47 | 1.44 | .562 | .140 | 1.062 | .812 | 1.094 | .120 | 5/8-24 UNEF | |
| 16 | 1-20 UNEF | 1.89 | 1.88 | .750 | .146 | 1.250 | .969 | 1.281 | | 7/8-20 UNEF | |
| 16S | | 1.47 | 1.47 | .562 | .140 | 1.25 HEX | | | | | |
| 18 | 1 1/8-18 UNEF | 1.98 | 1.97 | .750 | .180 | 2.062 | 1.062 | 1.375 | | 1-20 UNEF | |
| 18S | | 1.82 | 1.82 | .562 | | 2.188 | 1.250 | 1.625 | | | |
| 22 | 1 3/8-18 UNEF | 1.98 | 1.97 | .750 | | | | | 1 3/16-18 UNEF | | |
| 24 | 1 1/2-18 UNEF | 2.25 | 2.25 | .812 | .203 | 1.719 | 1.375 | 1.750 | .147 | 1 7/16-18 UNEF | |
| 32 | 2-18 UNS | 2.38 | 2.38 | .875 | | 1.62 HEX | 2.219 | 1.750 | 2.250 | .173 | 1 3/4-18 UNS |
| 36 | 2 1/4-16 UNS | | | | | 2.469 | 1.938 | 2.500 | 2-18 UNS | | |
| 50 | 3 1/8-16 UN | 3.50 | 3.70 | .810 | .210 | 3.37 HEX | 3.75 B.C. | 4.25 DIA. | .221, 6 PL. | | 2 1/4-16 UN |

CMC-Series CONNECTOR ACCESSORIES

CONNECTRONICS MANUFACTURES SPECIALTY SHIELD TERMINATION AND STRAIN RELIEF HARDWARE. LET US DESIGN A CUSTOM SOLUTION FOR YOU.

R.A. BACKSHELL HARDWARE

AVAILABLE WITH OR WITHOUT SHIELD TERMINATION HARDWARE. CONSULT FACTORY FOR PART NUMBERS AND AVAILABILITY

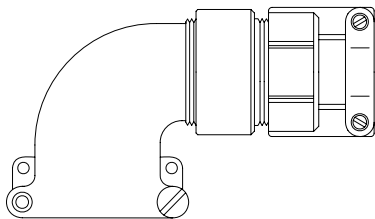

CABLE CLAMP

AVAILABLE WITH OR WITHOUT SHIELD TERMINATION HARDWARE. CONSULT FACTORY FOR PART NUMBERS AND AVAILABILITY

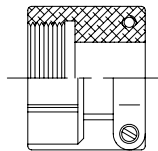

NYLON POTTING BOOT

CONFIGURATION MAY VARY BY SIZE CONSULT FACTORY FOR PART NUMBERS AND AVAILABILITY

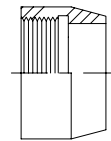

CMC Series INSULATOR CONFIGURATIONS



| | |
|--------------------------------|---------|
| 5 PIN | 10 KVDC |
| SHELL Sz. 12 | |
| #22 CONTACTS | 5 AMPS |
| PART NUMBERS | |
| PLUG w/ PINS 11169-XX | |
| PLUG w/ SOCKETS 10099-XX | |
| RECEPTACLE w/ PINS 10100-XX | |
| RECEPTACLE w/ SOCKETS 11168-XX | |



| | |
|--------------------------------|---------|
| 4 PIN | 15 KVDC |
| SHELL Sz. 18S | |
| #16 CONTACTS | 10 AMPS |
| PART NUMBERS | |
| PLUG w/ PINS 11304-XX | |
| PLUG w/ SOCKETS 11305-XX | |
| RECEPTACLE w/ PINS 11308-XX | |
| RECEPTACLE w/ SOCKETS 11309-XX | |



| | |
|--------------------------------|----------|
| 13 PIN | 15 KVDC |
| SHELL Sz. 22 | |
| #20 CONTACTS | 7.5 AMPS |
| PART NUMBERS | |
| PLUG w/ PINS 11100-XX | |
| PLUG w/ SOCKETS 11161-XX | |
| RECEPTACLE w/ PINS 11162-XX | |
| RECEPTACLE w/ SOCKETS 11101-XX | |

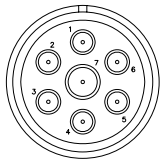

| | |
|--------------------------------|----------|
| 7 PIN | 50 KVDC |
| SHELL Sz. 32 | |
| 40 KVDC - CENTER PIN | |
| #20 CONTACTS | 7.5 AMPS |
| PART NUMBERS | |
| PLUG w/ PINS 11563-XX | |
| PLUG w/ SOCKETS 11565-XX | |
| RECEPTACLE w/ PINS 11566-XX | |
| RECEPTACLE w/ SOCKETS 11564-XX | |

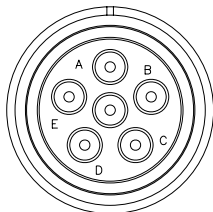

| | |
|--------------------------------|---------|
| 6 PIN | 50 KVDC |
| SHELL Sz. 50 | |
| #12 CONTACTS | 23 AMPS |
| PLASTIC INSULATOR PIN SIDE | |
| PART NUMBERS | |
| PLUG w/ PINS 11304-XX | |
| PLUG w/ SOCKETS 11305-XX | |
| RECEPTACLE w/ PINS 11308-XX | |
| RECEPTACLE w/ SOCKETS 11309-XX | |



| | |
|--------------------------------|---------|
| 2 PIN | 20 KVDC |
| SHELL Sz. 16S | |
| #16 CONTACTS | 10 AMPS |
| PLASTIC INSULATOR PIN SIDE | |
| PART NUMBERS | |
| PLUG w/ PINS 11561-XX | |
| PLUG w/ SOCKETS 11230-XX | |
| RECEPTACLE w/ PINS 11231-XX | |
| RECEPTACLE w/ SOCKETS 11562-XX | |



| | |
|--------------------------------|---------|
| 1 PIN | 30 KVDC |
| SHELL Sz. 18 | |
| #16 CONTACT | 10 AMPS |
| PART NUMBERS | |
| PLUG w/ PINS 10815-XX | |
| PLUG w/ SOCKETS 10824-XX | |
| RECEPTACLE w/ PINS 10825-XX | |
| RECEPTACLE w/ SOCKETS 10816-XX | |

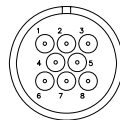

| | |
|---------------------------------------|----------|
| 8 PIN | 20 KVDC |
| SHELL Sz. 24 | |
| OPTIONAL PLASTIC INSULATOR - PIN SIDE | |
| #20 CONTACTS | 7.5 AMPS |
| PART NUMBERS | |
| PLUG w/ PINS 10303-XX | |
| PLUG w/ SOCKETS 10305-XX | |
| RECEPTACLE w/ PINS 10306-XX | |
| RECEPTACLE w/ SOCKETS 10304-XX | |

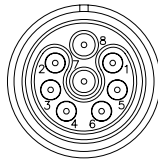

| | |
|--------------------------------|----------|
| 8 PIN | 20 KVDC |
| SHELL Sz. 32 | |
| 30 KVDC - PIN 7 & 8 | |
| #20 CONTACTS | 7.5 AMPS |
| PART NUMBERS | |
| PLUG w/ PINS 11567-XX | |
| PLUG w/ SOCKETS 11569-XX | |
| RECEPTACLE w/ PINS 11568-XX | |
| RECEPTACLE w/ SOCKETS 11570-XX | |



| | |
|--------------------------------|----------|
| 7 PIN | 15 KVDC |
| SHELL Sz. 16 | |
| #20 CONTACTS | 7.5 AMPS |
| PART NUMBERS | |
| PLUG w/ PINS 10018-XX | |
| PLUG w/ SOCKETS 10124-XX | |
| RECEPTACLE w/ PINS 10243-XX | |
| RECEPTACLE w/ SOCKETS 10098-XX | |



| | |
|--------------------------------|---------|
| 1 PIN | 45 KVDC |
| SHELL Sz. 22 | |
| #16 CONTACT | 10 AMPS |
| PART NUMBERS | |
| PLUG w/ PINS 10892-XX | |
| PLUG w/ SOCKETS 10894-XX | |
| RECEPTACLE w/ PINS 10895-XX | |
| RECEPTACLE w/ SOCKETS 10893-XX | |

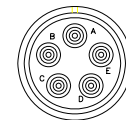

| | |
|--------------------------------|----------|
| 5 PIN | 20 KVDC |
| SHELL Sz. 24 | |
| PLASTIC INSULATOR PIN SIDE | |
| #20 CONTACTS | 7.5 AMPS |
| PART NUMBERS | |
| PLUG w/ PINS 11553-XX | |
| PLUG w/ SOCKETS 11555-XX | |
| RECEPTACLE w/ PINS 11554-XX | |
| RECEPTACLE w/ SOCKETS 11556-XX | |

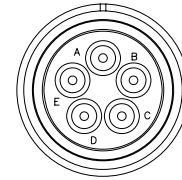

| | |
|--------------------------------|---------|
| 5 PIN | 50 KVDC |
| SHELL Sz. 36 | |
| #12 CONTACTS | 23 AMPS |
| PART NUMBERS | |
| PLUG w/ PINS 11557-XX | |
| PLUG w/ SOCKETS 11559-XX | |
| RECEPTACLE w/ PINS 11558-XX | |
| RECEPTACLE w/ SOCKETS 11560-XX | |

INSULATOR CONFIGURATIONS SHOWN ARE PIN CONTACT MATING FACES
REFER TO BASE PART NUMBERS LISTED WHEN REQUESTING ADDITIONAL INFORMATION
REGARDING HARDWARE PLATING, AND BACKSHELL HARDWARE OPTIONS.

15 KVDC, 7 PIN CONNECTORS SHOWN IN CLEAR CADMIUM PLATED HARDWARE, BACKSHELLS NOT SHOWN FOR CLARITY

HERMETICALLY SEALED CERAMIC RECEPTACLES ARE AVAILABLE. CERAMIC TO METAL SEALED CONNECTORS UTILIZE PIN CONTACTS AND COME IN A VARIETY OF PANEL MOUNTING FLANGE STYLES. CONSULT FACTORY FOR ADDITIONAL INFORMATION.



CERAMIC RECEPTACLE TO MATE WITH 11559-XX PLUG



PIN AND SOCKET CONTACT INSULATORS ARE DESIGNED TO BE INTERCHANGEABLE, ALLOWING THEM TO BE ASSEMBLED INTO PLUG OR RECEPTACLE SHELLS TO MEET THE NEEDS OF YOUR SPECIFIC APPLICATION.

CMC-Series TECHNICAL DATA

DESCRIPTION

CONNECTRONICS' "CMC-SERIES" CONNECTOR ASSEMBLIES UTILIZE TAPERED INTERFACES TO ENSURE CORONA FREE OPERATION THROUGH ALTITUDE AND TEMPERATURE EXTREMES. VARIOUS INTERFACE LAYOUTS, SHELL SIZES AND OPERATING VOLTAGES ARE AVAILABLE TO MEET YOUR CUSTOM REQUIREMENTS. THE "CMC-SERIES" MULTI-CONTACT CONNECTORS OFFER MULTIPLE HIGH VOLTAGE CONNECTIONS WITHIN A COMMON SHELL. THIS CONCEPT OFFERS MAXIMUM RELIABILITY AT A LOW COST FOR THE MOST DEMANDING APPLICATIONS.

OPERATING CHARACTERISTICS:

ELECTRICAL:

VOLTAGE - SEE INSULATOR CONFIGURATIONS
MAXIMUM CURRENT - SEE INSULATOR CONFIGURATIONS

ENVIRONMENTAL:

ALTITUDE - SEA LEVEL TO 70,000 FT.
TEMPERATURE - -55°C TO +125°C

MATERIALS AND FINISHES:

SHELL, COUPLING NUT AND RELATED HARDWARE - ALUMINUM ALLOY IN ACCORDANCE WITH MIL-C-5015, MS3100 SERIES.

CLEAR, BLACK, OR OLIVE DRAB CADMIUM PLATED PER QQ-P-416, OR ELECTROLESS NICKEL PLATED PER MIL-C-26074. OPTIONAL STAINLESS STEEL PER ASTM A582, PASSIVATED PER QQ-P-35 IS ALSO AVAILABLE.

INSULATORS - SILICONE RUBBER PER ZZ-R-765.

(THERMOSET) GLASS FILLED EPOXY OR DIALLYL PHTHALATE PER MIL-M-14 AVAILABLE ON SPECIFIED CONNECTORS.

SOCKET CONTACTS - COMMERCIAL BRONZE, GOLD PLATED PER MIL-G-45204.

PIN CONTACTS - BRASS, GOLD PLATED PER MIL-G-45204.

WIRE (OPTIONAL) - #16 AWG THRU #24 AWG STRANDED, SILICONE, TEFLON OR SILICONE COATED TEFLON INSULATED.

CABLE

SEVERAL MULTI-CONDUCTOR SHIELDED OR UN-SHIELDED CABLE CONSTRUCTIONS ARE IN STOCK AND AVAILABLE FOR USE WITH THE CMC MULTI-CONTACT SERIES CONNECTORS.

ORDERING INFORMATION

CONNECTORS CAN BE ORDERED WITH THE FOLLOWING HARDWARE PLATING OPTIONS:

CLEAR CADMIUM, OLIVE DRAB CADMIUM, BLACK CADMIUM OR ELECTROLESS NICKEL

ADDITIONAL OPTIONS INCLUDE VARIOUS REAR HARDWARE CONFIGURATIONS FOR SHIELDED OR UN-SHIELDED CABLE.

CONNECTOR "KITS" ARE SUPPLIED WITH INSULATORS BONDED INTO PLUG OR RECEPTACLE SHELLS

CONSULT FACTORY FOR PROPER PART NO. DESIGNATIONS ACCORDING TO DESIRED OPTIONS. (CONTACTS PACKAGED SEPARATELY)

ALSO AVAILABLE FROM CONNECTRONICS ARE OPTIONS FOR OVERMOLDED ENVIRONMENTAL STRAIN RELIEFS FOR USE IN DEMANDING ENVIRONMENTAL APPLICATIONS. CONSULT FACTORY FOR PRODUCT AVAILABILITY AND ADDITIONAL INFORMATION.

FOR OPTIMUM PERFORMANCE, LET CONNECTRONICS TERMINATE AND ELECTRICALLY TEST CONNECTORS TO YOUR SPECIFICATIONS TO CREATE A CUSTOM CABLE ASSEMBLY CONFIGURATION.

Connectronics
Corp. Interconnection Specialists
Phone: 419-537-0020